

**shindaiwa®**

# **SPECIFICATIONS**

**Diesel Engine Generator**

# **DGK25F**

# **CONTENTS**

## **CHAPTER 1: GENERAL .....1**

- 1. Application**
- 2. Standard**
- 3. Design Condition**
- 4. Test and Check**
- 5. Painting**
- 6. Structure**

## **CHAPTER 2: SPECIFICATIONS .....2**

## **CHAPTER 3: EQUIPMENT AND FEATURE .....3**

- 1. Equipment**
  - (1) Generator**
  - (2) Safety Device**
  - (3) Equipment**
- 2. Feature .....4**
  - (1) Feature**
  - (2) Protection Device**
  - (3) Fuel Economy .....5**
  - (4) Accessories**

## **CHAPTER 4: APPEARANCE .....6**

# **CHAPTER 1: GENERAL**

## **1. Application**

- (1) Power Source for light, electric tools and appliances.

## **2. Standard**

Design and production are in conformity with:

- (1) Japan Industrial Standards: JIS C 9300-1
- (2) Low Noise Type Construction Machinery Standard
- (3) EPA Tier 4 final

## **3. Design Condition**

- (1) Installation Place: Outside
- (2) Ambient Temperature: 5 to 104° F (-15 to +40°C)
- (3) Humidity: Less than 85%
- (4) Altitude: Less than 984 ft. (300 meters) above sea level

## **4. Test and Check**

Test shall be done with a complete workable unit of the diesel engine unit.

Check Items:

- (1) Insulation and Dielectric Test
- (2) Starting
- (3) Protection Device Working Test
- (4) Voltage Deviation and Speed Variation: 0-4/4 Load
- (5) Load Test: Welding and Generating 4/4 Load

## **5. Painting**

Painting and color specifications are as per manufacturer's standard.

## **6. Structure**

- (1) Vibration Proof Device  
Alternator is directly coupled with engine and both are installed on the bed through the vibration proof device.
- (2) Low Noise  
Low noise structure is put in the inside of the bonnet.  
Sound Level: 58dB(A) @7m distance under no load.
- (3) Fuel Tank  
A steel fuel tank is equipped and incorporated with the electrical level gauge.

## CHAPTER 2: SPECIFICATIONS

Model		Unit		DGK25F	
Alternator	Generator Type	-		Revolving Field Brushless	
	Rated Frequency	Hz		60	
	Rated Output(Prime)	Three phase	kVA	25	
			kW	20	
		Single phase	kVA	15 [7.5] *1	
			kW	15 [7.5] *1	
	Standby Output	Three phase	kVA	27.5	
			kW	22	
		Single phase	kVA	16.5 [8.3] *1	
			kW	16.5 [8.3] *1	
	Rated Voltage	Three phase	V	208/240/ [480] *1	
		Single phase	V	120/139/240/[277] *1	
	Rated Current	Three phase-208V	A	60	
		Three phase-240V	A	60	
		Three phase-480V	A	30	
		Single phase-120V	A	62.5×2 [31.3 x 2]*1	
		Single phase-240V	A	62.5 [31.3]*1	
Power Factor	-		Three phase 0.8, Single phase 1.0		
Insulation class	-		F		
Excitation	-		Self-Excitation (brushless)		
No. of Poles	-		4		
Engine	Type	-		Vertical Water-Cooled 4-Cycle Diesel	
	Model(Manufacturer)	-		4LE2T(ISUZU)	
	No. of Cylinders (bore × stroke)	(in./mm)		4(3.35×3.78/85x96)	
	Continuous Rated Output	hp		33.5	
	Rated Speed	rpm		1,800	
	Displacement	cu.in./liters		133/2.179	
	Combustion System	-		Direct injection (Turbo-charged)	
	Cooling Method	-		Water cooled	
	Starting Method	-		Electric	
	Fuel	-		No.2-D,S15 EPA regulation	
	Lubricating Oil	-		API service-type CJ-4 class	
	Fuel Tank Capacity	gal./liters		51.5/195	
	Lubricant Volume	gal./liters		2.7/10.4(including filter 0.1/0.4)	
	Cooling Water Volume	gal./liters		2.6/10(including sub-tank 0.3/1.0)	
	Starting Motor Capacity	V-kW		12-2.0	
	Charging Alternator Capacity	V-A		12-50	
Battery Capacity	V-Ah		12-72		
Unit	Length	in./mm		63/1,603	
	Width	in./mm		33/850	
	Height	in./mm		55/1,400	
	Dry Weight	lbs./kg		1,929/875	
	Net Weight	lbs./kg		2,359/1,070	

\*Specifications subject to change without notice.

# CHAPTER 3: EQUIPMENT AND FEATURE

## 1. Equipment

### (1) Generator

Voltage Meter .....	1 pc.
Amp. Meter .....	1 pc.
Freq. Meter .....	1 pc.
Voltage Regulator .....	1 pc.
Amp. Meter Selector .....	1 pc.
Breaker Trip Selector .....	1 pc.
Voltage Selector Switch .....	1 pc.
Single Phase Receptacle (120V) .....	2 pcs.
Single Phase Receptacle (240/120V) .....	2 pcs.

### (2) Safety Device

#### Breaker

● Main Breaker (3-Phase) .....	1 pc.
● Main Breaker (1-Phase) .....	1 pc.
● 3-Phase Breaker .....	1 pc.
● 1-Phase Breaker .....	1 pc.

#### Protection Monitor..... 1 pc.

- Battery Charge
- Air Filter
- Engine Malfunction
- Spill Containment (with auto engine shut off feature)
- Oil Pressure (with auto engine shut off feature)
- Water Temp. (with auto engine shut off feature)
- Over Speed (with auto engine shut off feature)

#### Door with locking feature (all external doors/covers)..... 1 each

- Right Door
- Left Door
- Front Panel
- Terminal Cover (2)
- Fuel Filling Cap Cover

Auto Shut off Feature (when some mechanical issue was detected.)

### (3) Equipment

Starting Switch .....	1 pc.
Throttle Switch (RUN/IDLE) .....	1 pc.
Engine Malfunction Monitor Lamp .....	1 pc.
Output Display Monitor (oil pressure/water temp./engine speed).....	1 pc.
Display Selector Switch.....	1 pc.
Monitor Lamp .....	1 pc.
Pilot Lamp .....	1 pc.

Glow Lamp (Preheat Lamp) .....	1 pc.
Output Selector Switch.....	1 pc.
(3-phase: 480/277V, 208/120V, 1-phase: 240/120V)	
Fuel Tank.....	1 pc.
Fuel Meter.....	1 pc.
Fuel Filter (w/ fuel strainer) .....	1 pc.
Spill Containment.....	1 pc.
Hour Meter.....	1 pc.
Engine Monitor.....	1 pc.
● Oil Pressure	
● Water Temp.	
● Engine Speed	
Breaker Trip Selector Switch.....	1 pc.
Air Cleaner.....	1 pc.
Fuel Drain Plug.....	1 pc.
Oil Drain Plug.....	1 pc.
Cooling Water Drain Plug.....	1 pc.
Noise Reduction Air Flow System .....	1 pc.
"Made in Japan"	

## 2. Feature

### (1) Feature

- Sound Level                      62DB(A) at 7m distance under no load
- "Simul Phase" (3-phase & 1-phase)
- Generating Performance      3-phase & 1-phase
- 2 Way Drive Control          Run/Idle
- Environmental                  EPA Tier 4 Final & Noise Reduction
- Fuel Tank Capacity            51.5 gal. (195 Liters)
- Dry Weight                      1,929 lbs. (875 kg)
- Dimensions (LxWxH)          63 x 33 x 55 in. (1,603 x 850 x 1400 mm)
- Made in Japan

### (2) Protection Device

Item	Set Value	Monitor Lamp	Auto Engine Shut off
Water Temp.	212° F/100°C	✓	✓
Oil Pressure	14psi/98kPa	✓	✓
Battery Charge	-	✓	-
Engine Speed	2070min <sup>-1</sup>	✓	✓
Air Filter	when clogged -	✓	
Spill Containment	17 gal./64.3 liters	✓	✓
Overload	Breaker trips.	-	-

(3) Fuel Economy

Criteria	Fuel Consumption	Continuous Operating Hrs
Full load	1.59 gal./hr (6.0L/hr.)	32
3/4 load	1.22 gal./hr (4.6 L/hr.)	42
1/2 load	0.92 gal./hr (3.5 L/hr.)	55
1/4 load	0.66 gal./hr. (2.5 L/hr.)	79
No Load	n/a	n/a

(4) Accessories

Owner's & Operator's Manual	1 copy
Engine Instruction Manual	1 copy
Starter Key	2 pcs.

**CHAPTER 4: APPEARANCE**

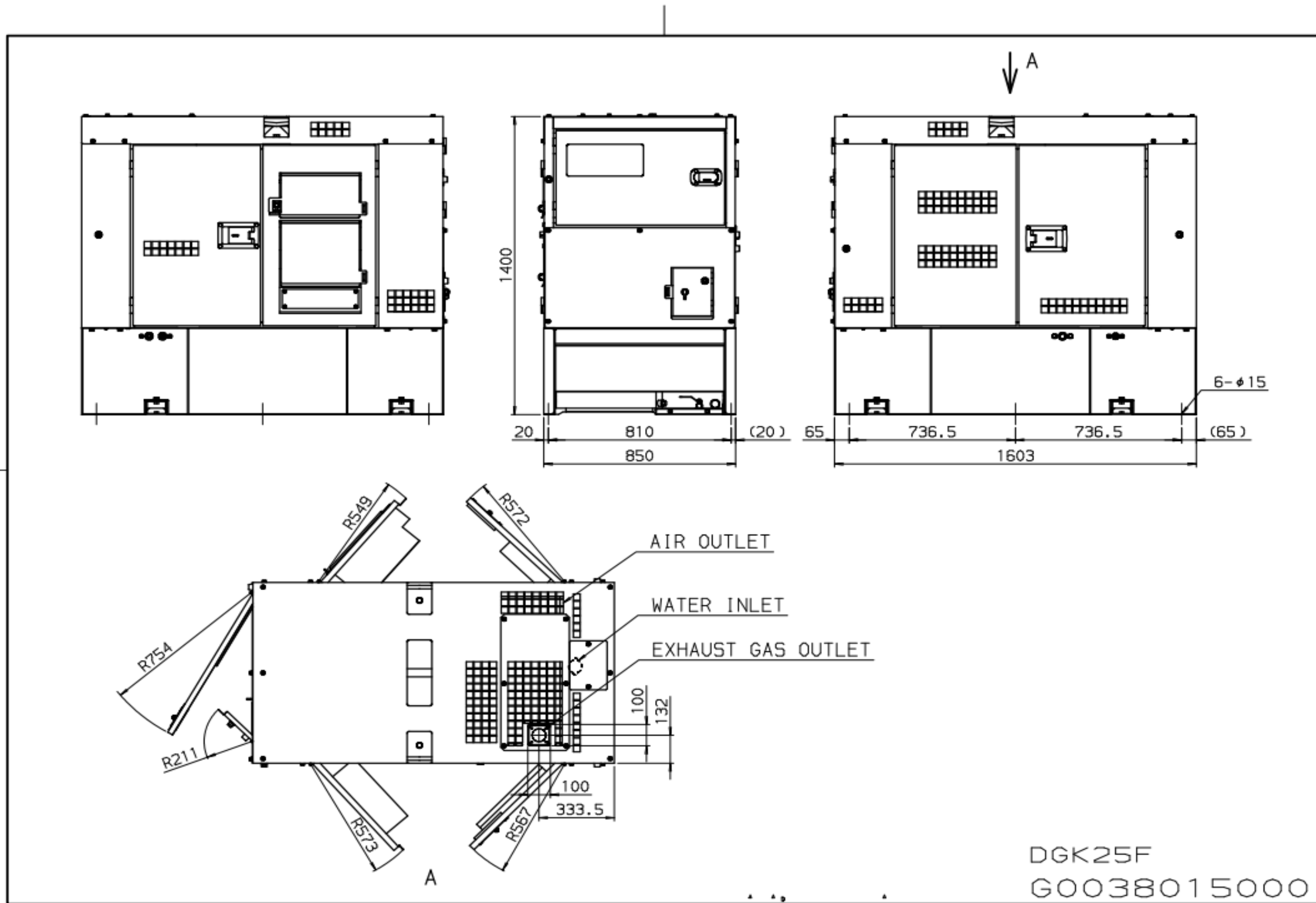



# **YAMABIKO CORPORATION**

**35 SHIN-UJIGAMI, KITA-HIROSHIMA-CHO,  
YAMAGATA-GUN, HIROSHIMA 731-1597 JAPAN**

**Telephone: (81)826-72-5140**

**Fax: (81) 826-72-7004**

**[www.yamabiko-corp.co.jp](http://www.yamabiko-corp.co.jp)**